



**US Army Corps
of Engineers**
Philadelphia District
1650 Arch Street
Philadelphia, PA 19103-2004
Attn: CENAP-OPR

Public Notice

Comment Period Begins: May 3, 2024
Comment Period Ends: May 18, 2024
File Number: NAP-2014-00605-24
File Name: NJDOT-OMR – Beach Creek State Channel #198
Maintenance Dredging Project
Contact: Robert Youhas
Email: robert.youhas@usace.army.mil

This District has received an application for a Department of the Army permit pursuant to Section 10 of the Rivers and Harbors Act of 1899 (33 U.S.C. 403) and Section 404 of the Clean Water Act (33 U.S.C. 1344).

The purpose of this notice is to solicit comments and recommendations from the public concerning issuance of a Department of the Army permit for the work described below.

This is a fifteen (15)-day supplemental Public Notice to a Public Notice that was issued on 31 July 2014.

APPLICANT: New Jersey Department of Transportation
Office of Maritime Resources
Attn: Ms. Genevieve Clifton
P.O. Box 600
1035 Parkway Avenue
Trenton, New Jersey 08625-0600

AGENT: WSP USA, Inc.
Attn: Ms. Katie Axt
250 W 34th Street, 4 FL
New York, New York 10119

LOCATION: Atlantic Ocean in City of North Wildwood, Cape May County, New Jersey. The proposed beach renourishment area is located between East 2nd Avenue (39.002112, -74.786998) and East 26th Avenue (38.987933, -74.801654); Hereford Inlet offshore borrow area located at approximately 39.003044, -74.770833.

PURPOSE: The stated purpose of this project is to provide for shore protection and recreational beach along a severely eroded beach berm area within a portion of the Hereford Inlet to Cape May Inlet Coastal Storm Risk Management Federal Civil Works Project.

PROJECT DESCRIPTION:

This Public Notice (PN) is a supplemental fifteen (15)-day Public Notice to a Public Notice that was issued on 31 July 2014 for DA Permit Number NAP-2014-00605-24. The 31 July 2014 PN was for proposed ten (10)-year hydraulic maintenance dredging of the New Jersey Department of Transportation – Office of Maritime Resources' (NJDOT-OMR's) Beach Creek State Channel #198, with placement of all resultant dredged material along North Wildwood's Atlantic Ocean-front shoreline between 2nd Avenue and 6th Avenue. Subsequently, on 02 September 2014, a Department of the Army permit was issued for the project. On 22 September 2015, a permit modification was issued by the Corps, which authorized placement of dredged material between 3rd Avenue and 7th Avenue. On 09 March 2017, a second permit modification was issued by the Corps, which authorized placement of dredged material into a deep trough area along the south side of Hereford Inlet; and rescinded Special Condition #9 of the 02 September 2014 DA permit, which prohibited dredging activities from 01 January to 31 May of any calendar year. DA Permit Number expires on 31 December 2024.

On 16 April 2024, the State of New Jersey's Governor's Office requested that NJDOT-OMR take immediate action and assist the City of North Wildwood with an emergency beach rehabilitation project to address severe erosion between East 2nd Avenue and East 26th Avenue, potentially jeopardizing public safety and damage to critical infrastructure and oceanfront property.

On 29 April 2024, the Corps received a permit modification request from NJDOT-OMR for DA authorization to complete a one-time shoreline renourishment event at a severely eroded Atlantic Ocean beach berm area between East 2nd Avenue and East 26th Avenue, which is sited within the federal design template of the Hereford Inlet to Cape May Inlet Coastal Storm Risk Management Federal Civil Works Project.

Specifically, a minimum of approximately 333,000.0-cubic yards, and up to a maximum of approximately 1,030,000.0-cubic yards, of beach compatible sand will be hydraulically dredged from the Hereford Inlet offshore borrow area and pumped via floating and submerged pipeline for direct placement along 7,900.0-linear feet (122.59-acres) of shoreline to a beach berm elevation of 6.5-feet NAVD88. Approximately 947,000.0-cubic yards out of the estimated maximum total of approximately 1,030,000.0- cubic yards would be placed within 110.0-acres below the High Tide Line. The dredged sand will be spread and graded within the fill area by bulldozers to authorized federal design template specifications. The proposed dredging and beach renourishment event is proposed to be undertaken between mid-May 2024 and late August 2024, with a total estimated construction duration of fifteen (15) weeks.

In order to undertake the one-time renourishment event, a one-time waiver of Special Conditions #13, #14, #15, and #16 is being coordinated with the U.S. Fish and Wildlife's New Jersey Field Office. Special Conditions #13, #14, #15, and #16 pertain to the protection of the following land-based threatened species under Section 7 of the Endangered Species Act: Piping Plover (*Charadrius melodus*), Rufa Red Knot (*Calidris*

canutus rufa), and Seabeach Amaranth (*Amaranthus pumilus*). Given the severely eroded condition of the shoreline between East 2nd Avenue and East 26th Avenue, these species and their habitat are anticipated to be absent from the action area.

For additional project details, see the attached plans identified as: E-1 and E-2, both entitled "NAP-2014-00605-24" and both dated 03 May 2024.

MITIGATION

The applicant has stated that the proposed project has been designed to avoid and minimize adverse effects on the aquatic environment to the maximum extent practicable. Information provided in the application and on the plans indicates that compensatory mitigation is neither practicable nor feasible for the amount of dredged or fill material to be discharged into waters of the United States.

Given that the proposed project would restore/renourish eroded shoreline within the federal design template of the Hereford Inlet to Cape May Inlet Coastal Storm Risk Management Federal Civil Works Project, compensatory mitigation is not proposed.

CORPS EVALUATION FACTORS

The decision whether to issue a permit will be based on an evaluation of the activity's probable impact including its cumulative impacts on the public interest. The decision will reflect the national concern for both protection and utilization of important resources. The benefits which reasonably may be expected to accrue from the work must be balanced against its reasonably foreseeable detriments. All factors which may be relevant to the work will be considered including the cumulative effects thereof. Among these factors are conservation, economics, aesthetics, general environmental concerns, wetlands, cultural values, fish and wildlife values, flood hazards, flood plain values, land use, navigation, shore erosion and accretion, recreation, water supply and conservation, water quality, energy needs, safety, food and fiber production, mineral needs and welfare of the people.

The evaluation of the impact of this project will also include application of the Clean Water Act Section 404(b)(1) Guidelines promulgated by the Administrator, U.S. Environmental Protection Agency if the project includes a discharge of dredge or fill material pursuant to Section 404 of the Clean Water Act.

Evaluation of the impact of the activity on the public interest will include application of the guidelines promulgated by the Administrator, EPA, (40 CFR part 230) or of the criteria established under authority of section 102(a) of the Marine Protection, Research and Sanctuaries Act of 1972.

In cases involving construction of artificial islands, installation and other devices on the outer continental shelf lands, the decision as to whether a permit will be issued will

be based on evaluation of the impact of the proposed work on navigation and national security.

ENDANGERED SPECIES

A preliminary review of this application indicates that species and/or their critical habitat pursuant to Section 7 of the Endangered Species Act (ESA) may be present in the action area. This office will forward this Public Notice to the U.S. Fish and Wildlife Service (USFWS) and/or National Marine Fisheries Service (NMFS) with a request for technical assistance on whether any ESA-listed species or their critical habitat may be present in the area which would be affected by the proposed activity. This office will evaluate the potential effects of the proposed actions on ESA-listed species or their critical habitat and will consult with the USFWS and/or NMFS, as appropriate. ESA Section 7 consultation would be concluded prior to the final decision on this permit application.

CULTURAL RESOURCES AND TRIBAL TRUST

The District's Cultural Resource Specialist and Tribal Liaison is currently reviewing the proposed permit action for potential impacts to Historic Properties eligible for or listed on the National Register of Historic Places and for potential issues concerning the Tribes. A determination of effects will be coordinated with the State Historic Preservation Office, the Tribes and other consulting parties as necessary.

ESSENTIAL FISH HABITAT

The Magnuson-Stevens Fishery Conservation and Management Act (MSA) requires all federal agencies to consult with the NMFS for all actions, or proposed actions, permitted, funded, or undertaken by the agency that may adversely affect Essential Fish Habitat (EFH). A preliminary review of this application indicates that EFH is present within the project area. This office will evaluate the potential effects of the proposed actions on EFH and will consult with NMFS, as appropriate. Consultation would be concluded prior to the final decision on this permit application.

WATER QUALITY CERTIFICATE

In accordance with Section 401 of the Clean Water Act, a Water Quality Certificate (WQC) is required from the State government in which the work is located. Any comments concerning the work described above which relate to Water Quality considerations should be sent to this office with a copy to the State.

COASTAL ZONE MANAGEMENT ACT

In accordance with Section 307(c) of the Coastal Zone Management Act of 1972, applicants for Federal Licenses or Permits to conduct an activity affecting land or water uses in a State's coastal zone must provide certification that the activity complies with

the State's Coastal Zone Management (CZM) Program. The applicant has stated that the proposed activity complies with and will be conducted in a manner that is consistent with the approved State CZM Program. Comments concerning the impact on the State's coastal zone should be sent to this office with a copy to the State's CZM office.

SUBMISSION OF COMMENTS AND PUBLIC HEARING REQUEST

Any comments received will be considered by this office to determine whether to issue, modify, condition, or deny a permit for this proposed project. To make this decision, comments are used to assess the probable impact on the public interest. Comments are also used to determine the need for a public hearing and to determine the overall public interest of the proposed activity.

Comments on the proposed work must be submitted, in writing, within the comment period indicated in the header above. Any person may request, within the comment period specified in this notice, that a public hearing be held to consider this application. Requests for a public hearing must be in writing and state the reasons for holding a public hearing.

Please provide any comments, request for a public hearing, or requests for additional information to the Regulatory Project Manager indicated above. All Public Notices are posted on our website at:

<https://www.nap.usace.army.mil/Missions/Regulatory/Public-Notices/>

FOR: Todd A. Schaible
Chief, Regulatory Branch

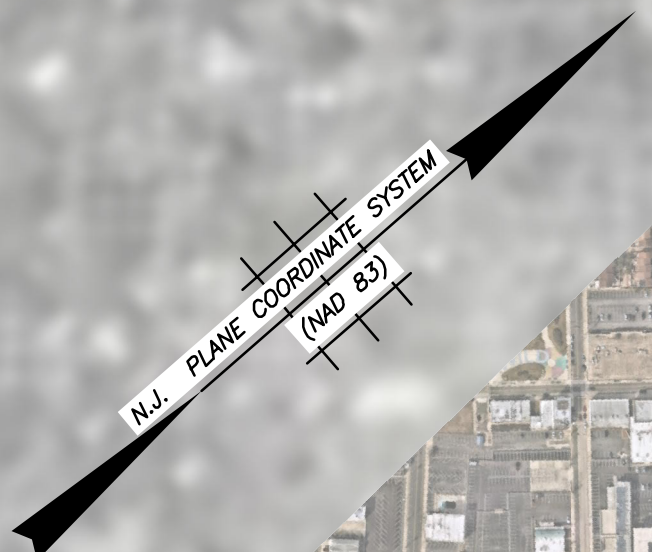

LOD AREA = 5,339,942 SF (122.59 AC.)

FILL AREA BELOW HTL = 4,833,378 SF (110.96 AC.)

ATLANTIC OCEAN

NOTES:

1. VERTICAL DATUM IS IN REFERENCE TO THE NORTH AMERICAN VERTICAL DATUM 1988 (NAVD88). NAVD88 IS 2.50 FEET ABOVE MEAN LOW WATER. INFORMATION OBTAINED FROM NATIONAL OCEANIC & ATMOSPHERIC ADMINISTRATION (NOAA) VDATUM TRANSFORMATION PROGRAM, VERSION 4.6.1
2. COORDINATES ARE EXPRESSED IN FEET AND REFER TO THE NEW JERSEY STATE PLANE GRID COORDINATE SYSTEM NORTH AMERICAN VERTICAL DATUM OF 1983 (NAD83).
3. EXISTING SHORELINE & DOCK LOCATIONS ARE BASED ON AERIAL IMAGERY AND SHOULD BE CONSIDERED APPROXIMATE.
4. AERIAL IMAGERY IS FROM NEARMAP WEB SERVICE DATED FEBRUARY 14, 2024.

LEGEND

- - - - - PROPERTY LINES
- - - - - APPROXIMATE PIPELINE ROUTE
- LOD — LIMIT OF DISTURBANCE
- — — — — HIGH TIDE LINE
- — — — — MEAN LOW WATER LINE
- - - - - LIMITS OF DREDGED MATERIAL BORROW AREA
- - - - - PROPOSED DREDGED MATERIAL BORROW AREA
- [Red Cross-hatch] PROPOSED BEACH BERM AREA (ELEV. 6.5 NAVD88)
- [Green Cross-hatch] FILL BELOW HIGH TIDE LINE

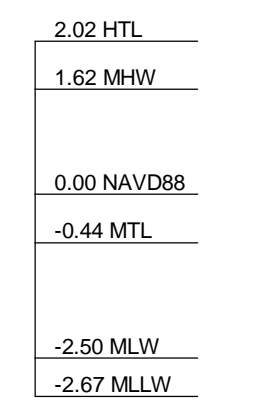

RANGE OF TIDE (FT)
NOT TO SCALE

BY / APPR.		DESCRIPTION		REV. DATE	

STATE OF NEW JERSEY	
NJDOT OFFICE OF MARITIME RESOURCES	
TITLE: PROPOSED DREDGED MATERIAL BORROW & PLACEMENT PLAN	
PROJECT: NORTH WILDWOOD EMERGENCY DREDGING AND BEACH REHABILITATION	
DRAWN BY: SF & JF	WSP USA Inc.
CHECKED BY: MJM	CERTIFICATION OF AUTHORIZATION NO. 24GA28029800
SCALE: AS SHOWN	MICHAEL J. MARANO NEW JERSEY PROFESSIONAL ENGINEER
DATE: MAY 2024	NO. 24GE04087500
PROJECT NO.	SHEET 1 OF 2
DWG. NO.	

GBA
ENGINEERS & SURVEYORS
9008 Yellow Brick Rd.
Unit D
Baltimore, MD 21287
Phone (410) 992-8988
JAKE MCTAVISH
NJ PE NO. 24GE0577100

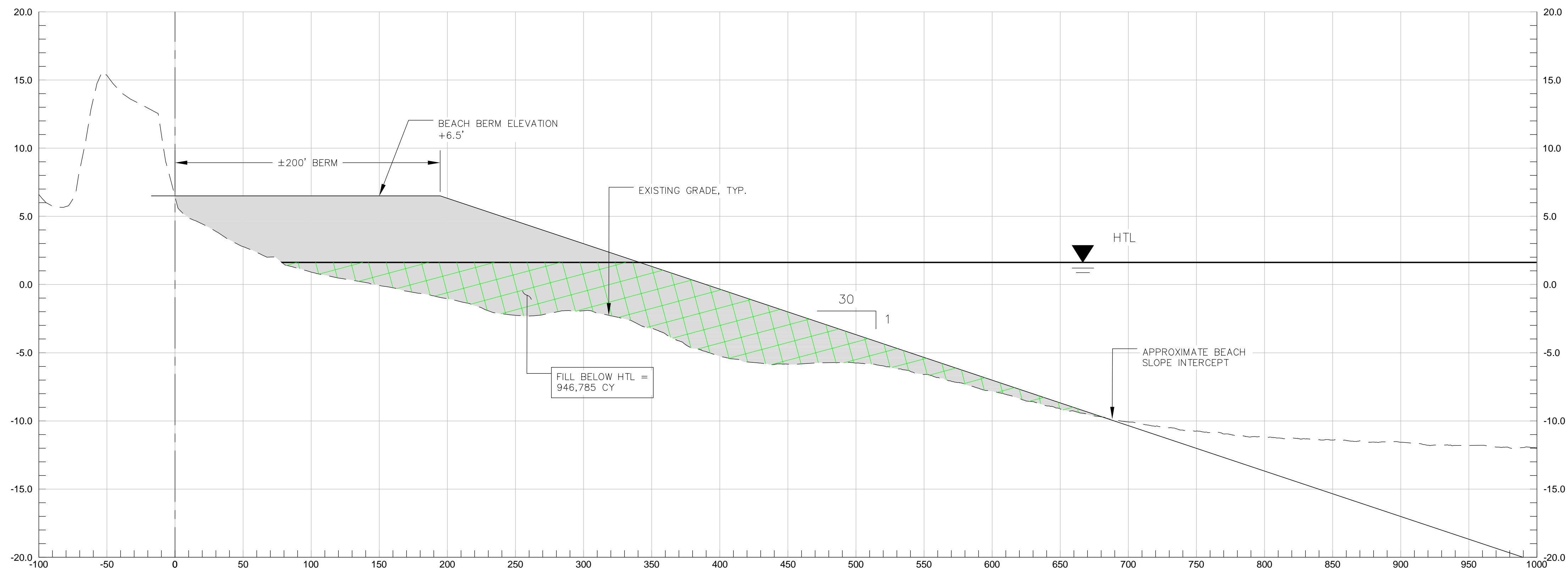

2.02 HTL
1.62 MHW
0.00 NAVD88
-0.44 MTL
-2.50 MLW
-2.67 MLLW

RANGE OF TIDE (FT)
NOT TO SCALE

LEGEND

PRECON SURVEY (BY GBA, APRIL 20-23, 2024)

PROPOSED BEACH FILL TEMPLATE

BASELINE OF CONSTRUCTION (BEACH)

PROPOSED BEACH FILL

FILL BELOW HTL

- NOTES:**
1. NORTH WILDWOOD BEACH HAS A REQUIRED BERM ELEVATION OF 6.5 FEET NAVD88 WITH 0.5 FOOT MAXIMUM ALLOWABLE OVERBUILD TOLERANCE (ELEV. 7.0 NAVD88) & 30:1 SLOPES.
 2. VERTICAL DATUM IS IN REFERENCE TO THE NORTH AMERICAN VERTICAL DATUM 1988 (NAVD88). NAVD88 IS 2.50 FEET ABOVE MEAN LOW WATER. INFORMATION OBTAINED FROM NATIONAL OCEANIC & ATMOSPHERIC ADMINISTRATION (NOAA) VDATUM DATUM TRANSFORMATION PROGRAM, VERSION 4.6.1.
 3. LIMITS OF PROPOSED BEACH FILL TO BE DETERMINED BASED ON THE RESULTS OF THE BEFORE DREDGE (BD) SURVEY.

H SCALE: 1" = 50'
V SCALE: 1" = 5'

BEACH PLACEMENT
CROSS SECTION (TYP.)

BY		APPR.		<p align="center">STATE OF NEW JERSEY NJDOT OFFICE OF MARITIME RESOURCES</p> <p>TITLE: PROPOSED DREDGED MATERIAL PLACEMENT SECTION</p> <p>PROJECT: NORTH WILDWOOD EMERGENCY DREDGING AND BEACH REHABILITATION</p>	
DESCRIPTION					
REV.		DATE			
DRAWN BY: SF & JF		WSP USA Inc.		PROJECT NO.	
CHECKED BY: MJM		CERTIFICATION OF AUTHORIZATION NO.		SHEET 2 OF 2	
SCALE: AS SHOWN		MICHAEL J. MARANO		DWG. NO.	
DATE: MAY 2024		NEW JERSEY PROFESSIONAL ENGINEER			
		NO. 24GE04087500			

GBA 9008 Yellow Brick Rd.
Unit D
Baltimore, MD 21287
Engineers & Surveyors Phone (410) 992-8988

JAKE MCTAVISH
NJ PE NO. 24GE0577100